

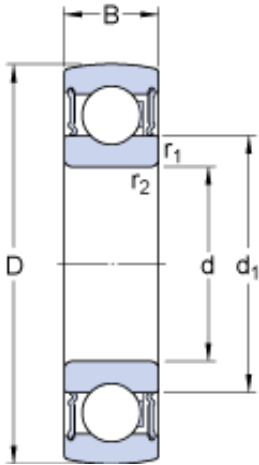

# KOYO PRECISION AXLE CORP.



45 mm x 85 mm x 19 mm SKF 1726209-2RS1  
deep groove ball bearings

Bearing No. 1726209-2RS1

1726209-2RS1 Bearing 2D drawings and 3D CAD models

Size	85x45x19 mm
Bore Diameter	85 mm
Outer Diameter	45 mm
Width	19 mm
d	45 mm
D	85 mm
B	19 mm
d <sub>1</sub>	57.6 mm
r <sub>1,2</sub> - min.	1.1 mm
Basic dynamic load rating - C	33.2 kN
Basic static load rating - C <sub>0</sub>	21.6 kN
Fatigue load limit - P <sub>u</sub>	0.915 kN
Limiting speed	5000 r/min
Calculation factor - f <sub>0</sub>	14
Category	Insert Bearings Spherical OD
Inventory	0.0
Manufacturer Name	SKF
Minimum Buy Quantity	N/A
Weight / Kilogram	0.37
EAN	7316577299031
Product Group	B00308
Inner Race Profile	Standard Inner Ring
Outer Race Profile	Spherical



## KOYO PRECISION AXLE CORP.

Relubricatable	No
Seal Type	RS1 Seal
Mounting Method	Shaft Mount
Rolling Element	Ball Bearing
Snap Ring	No
Long Description	45MM Bore; Standard Inner Ring; Ball Bearing; 19MM Length Thru Bore; 19MM Outer Race Width; 85MM Outside Diameter; Not Relubricatable; RS1 Seal Seal; Shaft Mount Mounting Method; No Snap Ring
Inch - Metric	Metric
Other Features	Single Row   Standard Duty   Metric
Category	Insert Bearings
UNSPSC	31171536
Harmonized Tariff Code	8482.10.50.00
Noun	Bearing
Keyword String	Insert
Manufacturer URL	<a href="http://www.skf.com">http://www.skf.com</a>
Manufacturer Item Number	1726209-2RS1
Weight / LBS	0.816
Outer Race Width	0.748 Inch   19 Millimeter
Outside Diameter	3.346 Inch   85 Millimeter
Bore	1.772 Inch   45 Millimeter
Length Thru Bore	0.748 Inch   19 Millimeter
bore diameter:	45 mm
internal clearance:	C0
outside diameter:	85 mm
operating temperature range:	-40 to +210 ° F
overall width:	19 mm
finish/coating:	Uncoated



## KOYO PRECISION AXLE CORP.

bore type:	Round
outer ring width:	19 mm
closure type:	Double Sealed
maximum rpm:	5000 RPM
snap ring included:	Without Snap Ring
series:	17262
$d_1$	56.6 mm
$r_{1,2}$ min.	1 mm
Basic dynamic load rating C	33.2 kN
Basic static load rating $C_0$	21.6 kN
Fatigue load limit $P_u$	0.915 kN
Limiting speed <sup>1)</sup>	5000 r/min
Calculation factor $f_0$	14
Mass complete bearing	0.4 kg